

Installation Information

Manufacturer	Tools	Color	Code
T&B	TBM5 TBM8	Gray	29
Panduit	CT-720 CT-920	Gray	P29
Burndy	Y1MR Y2MR	Gray	8
Celestra	A45	Gray	29

Cat. Nos	Wire Size		Dimension (in.)					Std. Pkg.
	Code	Flex Class G,H,I,K,M	Bolt Size	B	C	R	ID	
DA0410A	4 AWG	40-50 Navy 133/.0177 49/.029 91/24 = 36.7 kcmil	#10	0.60	0.55	0.75	0.27	100
DA0414A	4 AWG	40-50 Navy 133/.0177 49/.029 91/24 = 36.7 kcmil	1/4	0.60	0.55	0.75	0.27	100
DA0456A	4 AWG	40-50 Navy 133/.0177 49/.029 91/24 = 36.7 kcmil	5/16	0.66	0.61	0.75	0.27	100
DA0438A	4 AWG	40-50 Navy 133/.0177 49/.029 91/24 = 36.7 kcmil	3/8	0.66	0.61	0.75	0.27	100
DA0412A	4 AWG	40-50 Navy 133/.0177 49/.029 91/24 = 36.7 kcmil	1/2	1.40	1.00	0.75	0.27	100
LA0410A	4 AWG	40-50 Navy 133/.0177 49/.029 91/24 = 36.7 kcmil	#10	0.65	0.52	1.05	0.27	100
LA0414A	4 AWG	40-50 Navy 133/.0177 49/.029 91/24 = 36.7 kcmil	1/4	0.65	0.52	1.05	0.27	100
DA0410A-250	4 AWG	40-50 Navy 133/.0177 49/.029 91/24 = 36.7 kcmil	#10	0.53	0.55	1.06	0.28	100
DA0414A-250	4 AWG	40-50 Navy 133/.0177 49/.029 91/24 = 36.7 kcmil	1/4	0.62	0.55	1.06	0.28	100
DA0456A-250	4 AWG	40-50 Navy 133/.0177 49/.029 91/24 = 36.7 kcmil	5/16	0.74	0.55	1.06	0.28	100
DA0438A-250	4 AWG	40-50 Navy 133/.0177 49/.029 91/24 = 36.7 kcmil	3/8	0.84	0.62	1.06	0.28	100
DA0414A-260	4 AWG	40-50 Navy 133/.0177 49/.029 91/24 = 36.7 kcmil	1/4	0.64	0.50	1.06	0.26	100
DA0410A-260	4 AWG	40-50 Navy 133/.0177 49/.029 91/24 = 36.7 kcmil	8-10	0.52	0.50	1.06	0.26	100
DA0456A-260	4 AWG	40-50 Navy 133/.0177 49/.029 91/24 = 36.7 kcmil	5/16	0.70	0.50	1.06	0.26	100
DA0438A-260	4 AWG	40-50 Navy 133/.0177 49/.029 91/24 = 36.7 kcmil	3/8	0.83	0.58	1.06	0.26	100
DA0412A-260	4 AWG	40-50 Navy 133/.0177 49/.029 91/24 = 36.7 kcmil	1/2	1.08	0.71	1.06	0.26	100
DA0410A-251	4 AWG	40-50 Navy 133/.0177 49/.029 91/24 = 36.7 kcmil	#10	0.53	0.55	0.78	0.28	100
DA0414A-251	4 AWG	40-50 Navy 133/.0177 49/.029 91/24 = 36.7 kcmil	1/4	0.62	0.55	0.78	0.28	100
DA0456A-251	4 AWG	40-50 Navy 133/.0177 49/.029 91/24 = 36.7 kcmil	5/16	0.74	0.55	0.78	0.28	100
DA0438A-251	4 AWG	40-50 Navy 133/.0177 49/.029 91/24 = 36.7 kcmil	3/8	0.84	0.62	0.78	0.28	100
DA0410A-252	4 AWG	40-50 Navy 133/.0177 49/.029 91/24 = 36.7 kcmil	#10	0.53	0.55	0.78	0.28	100
DA0414A-252	4 AWG	40-50 Navy 133/.0177 49/.029 91/24 = 36.7 kcmil	1/4	0.62	0.55	0.78	0.28	100
DA0456A-252	4 AWG	40-50 Navy 133/.0177 49/.029 91/24 = 36.7 kcmil	5/16	0.74	0.55	0.78	0.28	100
DA0438A-252	4 AWG	40-50 Navy 133/.0177 49/.029 91/24 = 36.7 kcmil	3/8	0.84	0.62	0.78	0.28	100
DA0410A-261	4 AWG	40-50 Navy 133/.0177 49/.029 91/24 = 36.7 kcmil	10-8	0.52	0.55	0.75	0.28	100
DA0412A-261	4 AWG	40-50 Navy 133/.0177 49/.029 91/24 = 36.7 kcmil	1/2	1.08	0.71	0.75	0.28	100
DA0414A-261	4 AWG	40-50 Navy 133/.0177 49/.029 91/24 = 36.7 kcmil	1/4	0.64	0.55	0.75	0.28	100
DA0438A-261	4 AWG	40-50 Navy 133/.0177 49/.029 91/24 = 36.7 kcmil	3/8	0.83	0.58	0.75	0.28	100
DA0456A-261	4 AWG	40-50 Navy 133/.0177 49/.029 91/24 = 36.7 kcmil	5/16	0.70	0.55	0.75	0.28	100
LA0410A-250	4 AWG	40-50 Navy 133/.0177 49/.029 91/24 = 36.7 kcmil	#10	0.53	0.55	1.30	0.28	100
LA0414A-250	4 AWG	40-50 Navy 133/.0177 49/.029 91/24 = 36.7 kcmil	1/4	0.62	0.55	1.30	0.28	100

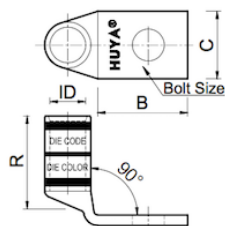

Installation Information

Manufacturer	Tools	Color	Code
T&B	TBM5 TBM8	Gray	29
Panduit	CT-720 CT-920	Gray	P29
Burndy	Y1MR Y2MR	Gray	8
Celestra	A45	Gray	29

Cat. Nos	Wire Size		Dimension (in.)					
	Code	Flex Class G,H,I,K,M	Bolt Size	B	C	R	ID	Std. Pkg.
LA0410A-260	4 AWG	40-50 Navy 133/.0177 49/.029 91/24 = 36.7 kcmil	#10	0.52	0.56	1.37	0.26	100
LA0414A-260	4 AWG	40-50 Navy 133/.0177 49/.029 91/24 = 36.7 kcmil	1/4	0.64	0.56	1.37	0.26	100
LA0438A-260	4 AWG	40-50 Navy 133/.0177 49/.029 91/24 = 36.7 kcmil	3/8	0.83	0.58	1.37	0.26	100
LA0412A-260	4 AWG	40-50 Navy 133/.0177 49/.029 91/24 = 36.7 kcmil	1/2	1.08	0.83	1.37	0.26	100
LA0414AP-260	4 AWG	40-50 Navy 133/.0177 49/.029 91/24 = 36.7 kcmil	1/4	0.64	0.49	1.37	0.26	100
LA0438AP-260	4 AWG	40-50 Navy 133/.0177 49/.029 91/24 = 36.7 kcmil	3/8	0.83	0.58	1.37	0.26	100
LA0412AP-260	4 AWG	40-50 Navy 133/.0177 49/.029 91/24 = 36.7 kcmil	1/2	1.08	0.83	1.37	0.26	100
LA0414AP-251	4 AWG	40-50 Navy 133/.0177 49/.029 91/24 = 36.7 kcmil	1/4	0.62	0.55	1.30	0.28	100
LA0438AP-251	4 AWG	40-50 Navy 133/.0177 49/.029 91/24 = 36.7 kcmil	3/8	0.84	0.62	1.30	0.28	100
LA0414AP-261	4 AWG	40-50 Navy 133/.0177 49/.029 91/24 = 36.7 kcmil	1/4	0.64	0.55	1.50	0.28	100
LA0438AP-261	4 AWG	40-50 Navy 133/.0177 49/.029 91/24 = 36.7 kcmil	3/8	0.83	0.58	1.50	0.28	100