

**Installation Information**

Manufacturer	Tools	Color	Code
T&B	TBM5 TBM8	Blue	24
Panduit	CT-720 CT-1700	Blue	P24
Burndy	Y1MR MY29	Blue	7
Celestra	A45	Blue	24

Cat. Nos	Wire Size		Dimension (in.)						Std. Pkg.
	Code	Flex Class G,H,I,K,M	Bolt Size	B	C	R	ID		
DA0610A	6 AWG	30 Navy 6 Weld 133/.014 61/24 = 24.6 kcmil	#10	0.53	0.44	0.70	0.22	100	
DA0614A	6 AWG	30 Navy 6 Weld 133/.014 61/24 = 24.6 kcmil	1/4	0.53	0.44	0.70	0.22	100	
DA0656A	6 AWG	30 Navy 6 Weld 133/.014 61/24 = 24.6 kcmil	5/16	0.67	0.60	0.70	0.22	100	
DA0638A	6 AWG	30 Navy 6 Weld 133/.014 61/24 = 24.6 kcmil	3/8	0.67	0.60	0.70	0.22	100	
LA0610A	6 AWG	30 Navy 6 Weld 133/.014 61/24 = 24.6 kcmil	#10	0.65	0.44	1.00	0.22	100	
LA0614A	6 AWG	30 Navy 6 Weld 133/.014 61/24 = 24.6 kcmil	1/4	0.65	0.44	1.00	0.22	100	
DA0610A-250	6 AWG	30 Navy 6 Weld 133/.014 61/24 = 24.6 kcmil	#10	0.53	0.45	1.01	0.22	100	
DA0614A-250	6 AWG	30 Navy 6 Weld 133/.014 61/24 = 24.6 kcmil	1/4	0.62	0.48	1.01	0.22	100	
DA0656A-250	6 AWG	30 Navy 6 Weld 133/.014 61/24 = 24.6 kcmil	5/16	0.74	0.56	1.01	0.22	100	
DA0638A-250	6 AWG	30 Navy 6 Weld 133/.014 61/24 = 24.6 kcmil	3/8	0.84	0.62	1.01	0.22	100	
DA0614A-260	6 AWG	30 Navy 6 Weld 133/.014 61/24 = 24.6 kcmil	1/4	0.64	0.45	1.01	0.22	100	
DA0610A-260	6 AWG	30 Navy 6 Weld 133/.014 61/24 = 24.6 kcmil	8-10	0.52	0.42	1.01	0.22	100	
DA0656A-260	6 AWG	30 Navy 6 Weld 133/.014 61/24 = 24.6 kcmil	5/16	0.70	0.52	1.01	0.22	100	
DA0638A-260	6 AWG	30 Navy 6 Weld 133/.014 61/24 = 24.6 kcmil	3/8	0.83	0.63	1.01	0.22	100	
DA0612A-260	6 AWG	30 Navy 6 Weld 133/.014 61/24 = 24.6 kcmil	1/2	1.08	0.75	1.01	0.22	100	
DA0610A-251	6 AWG	30 Navy 6 Weld 133/.014 61/24 = 24.6 kcmil	#10	0.53	0.45	0.68	0.22	100	
DA0614A-251	6 AWG	30 Navy 6 Weld 133/.014 61/24 = 24.6 kcmil	1/4	0.62	0.48	0.68	0.22	100	
DA0656A-251	6 AWG	30 Navy 6 Weld 133/.014 61/24 = 24.6 kcmil	5/16	0.74	0.56	0.68	0.22	100	
DA0638A-251	6 AWG	30 Navy 6 Weld 133/.014 61/24 = 24.6 kcmil	3/8	0.84	0.62	0.68	0.22	100	
DA0610A-252	6 AWG	30 Navy 6 Weld 133/.014 61/24 = 24.6 kcmil	#10	0.53	0.45	0.68	0.22	100	
DA0614A-252	6 AWG	30 Navy 6 Weld 133/.014 61/24 = 24.6 kcmil	1/4	0.62	0.48	0.68	0.22	100	
DA0656A-252	6 AWG	30 Navy 6 Weld 133/.014 61/24 = 24.6 kcmil	5/16	0.74	0.56	0.68	0.22	100	
DA0638A-252	6 AWG	30 Navy 6 Weld 133/.014 61/24 = 24.6 kcmil	3/8	0.84	0.62	0.68	0.22	100	
DA0610A-261	6 AWG	30 Navy 6 Weld 133/.014 61/24 = 24.6 kcmil	8-10	0.52	0.48	0.70	0.22	100	
DA0612A-261	6 AWG	30 Navy 6 Weld 133/.014 61/24 = 24.6 kcmil	1/2	1.08	0.75	0.70	0.22	100	
DA0614A-261	6 AWG	30 Navy 6 Weld 133/.014 61/24 = 24.6 kcmil	1/4	0.64	0.48	0.70	0.22	100	
DA0638A-261	6 AWG	30 Navy 6 Weld 133/.014 61/24 = 24.6 kcmil	3/8	0.83	0.60	0.70	0.22	100	
DA0656A-261	6 AWG	30 Navy 6 Weld 133/.014 61/24 = 24.6 kcmil	5/16	0.70	0.60	0.70	0.22	100	
DA0634A-261	6 AWG	30 Navy 6 Weld 133/.014 61/24 = 24.6 kcmil	3/4	1.52	1.05	0.70	0.22	100	
WP0614A-112	6 AWG	30 Navy 6 Weld 133/.014 61/24 = 24.6 kcmil	1/4	0.52	0.44	0.65	0.21	100	
LA0610A-250	6 AWG	30 Navy 6 Weld 133/.014 61/24 = 24.6 kcmil	#10	0.53	0.45	1.27	0.22	100	

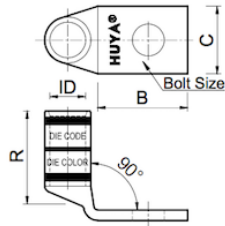

**Installation Information**

Manufacturer	Tools	Color	Code
T&B	TBM5 TBM8	Blue	24
Panduit	CT-720 CT-1700	Blue	P24
Burndy	Y1MR MY29	Blue	7
Celestra	A45	Blue	24

Cat. Nos	Wire Size		Dimension (in.)					
	Code	Flex Class G,H,I,K,M	Bolt Size	B	C	R	ID	Std. Pkg.
LA0614A-250	6 AWG	30 Navy 6 Weld 133/.014 61/24 = 24.6 kcmil	1/4	0.62	0.48	1.27	0.22	100
LA0638A-250	6 AWG	30 Navy 6 Weld 133/.014 61/24 = 24.6 kcmil	3/8	0.84	0.62	1.27	0.22	100
LA0610A-260	6 AWG	30 Navy 6 Weld 133/.014 61/24 = 24.6 kcmil	#10	0.52	0.41	1.32	0.22	100
LA0612A-260	6 AWG	30 Navy 6 Weld 133/.014 61/24 = 24.6 kcmil	1/2	1.08	0.83	1.32	0.22	100
LA0614A-260	6 AWG	30 Navy 6 Weld 133/.014 61/24 = 24.6 kcmil	1/4	0.64	0.41	1.32	0.22	100
LA0614AP-260	6 AWG	30 Navy 6 Weld 133/.014 61/24 = 24.6 kcmil	1/4	0.64	0.48	1.32	0.22	100
LA0638AP-260	6 AWG	30 Navy 6 Weld 133/.014 61/24 = 24.6 kcmil	3/8	0.83	0.58	1.32	0.22	100
LA0612AP-260	6 AWG	30 Navy 6 Weld 133/.014 61/24 = 24.6 kcmil	1/2	1.08	0.83	1.32	0.22	100
LA0614AP-251	6 AWG	30 Navy 6 Weld 133/.014 61/24 = 24.6 kcmil	1/4	0.62	0.48	1.27	0.22	100
LA0638AP-251	6 AWG	30 Navy 6 Weld 133/.014 61/24 = 24.6 kcmil	3/8	0.84	0.62	1.27	0.22	100
LA0614AP-261	6 AWG	30 Navy 6 Weld 133/.014 61/24 = 24.6 kcmil	1/4	0.64	0.48	0.95	0.22	100
LA0638AP-261	6 AWG	30 Navy 6 Weld 133/.014 61/24 = 24.6 kcmil	3/8	0.83	0.58	0.95	0.22	100