

Installation Information

Manufacturer	Tools	Color	Code
T&B	TBM5 TBM8	Red	21
Panduit	CT-720 CT-920	Red	P21
Burndy	Y1MR Y2MR	Red	49
Celestra	A45	Red	21

Cat. Nos	Wire Size		Dimension (in.)						Std. Pkg.
	Code	Flex Class G,H,I,K,M	Bolt Size	B	C	R	ID		
LA0810A	8 AWG	23 Navy #8 Weld 37/24 = 14.9 kcmil #6 SOL	#10	0.65	0.42	0.93	0.18	100	
LA0814A	8 AWG	23 Navy #8 Weld 37/24 = 14.9 kcmil #6 SOL	1/4	0.65	0.42	0.93	0.18	100	
LA0810A-250	8 AWG	23 Navy #8 Weld 37/24 = 14.9 kcmil #6 SOL	#10	0.53	0.41	0.88	0.18	100	
LA0814A-250	8 AWG	23 Navy #8 Weld 37/24 = 14.9 kcmil #6 SOL	1/4	0.62	0.48	0.88	0.18	100	
LA0810A-260	8 AWG	23 Navy #8 Weld 37/24 = 14.9 kcmil #6 SOL	#10	0.52	0.41	0.99	0.18	100	
LA0814A-260	8 AWG	23 Navy #8 Weld 37/24 = 14.9 kcmil #6 SOL	1/4	0.64	0.41	0.99	0.18	100	
LA0838A-260	8 AWG	23 Navy #8 Weld 37/24 = 14.9 kcmil #6 SOL	3/8	0.83	0.60	0.99	0.18	100	
LA0810AP-261	8 AWG	23 Navy #8 Weld 37/24 = 14.9 kcmil #6 SOL	#10	0.52	0.41	0.93	0.18	100	
LA0814AP-261	8 AWG	23 Navy #8 Weld 37/24 = 14.9 kcmil #6 SOL	1/4	0.64	0.44	0.93	0.18	100	
LA0838AP-261	8 AWG	23 Navy #8 Weld 37/24 = 14.9 kcmil #6 SOL	3/8	0.83	0.60	0.93	0.18	100	
LA0838AP-251	8 AWG	23 Navy #8 Weld 37/24 = 14.9 kcmil #6 SOL	3/8	0.84	0.60	0.88	0.18	100	
WP0814A-104	8 AWG	23 Navy #8 Weld 37/24 = 14.9 kcmil #6 SOL	1/4	0.52	0.41	0.61	0.18	100	
LA0810AP-260	8 AWG	23 Navy #8 Weld 37/24 = 14.9 kcmil #6 SOL	#10	0.52	0.41	0.99	0.18	100	
LA0814AP-260	8 AWG	23 Navy #8 Weld 37/24 = 14.9 kcmil #6 SOL	1/4	0.64	0.44	0.99	0.18	100	
LA0838AP-260	8 AWG	23 Navy #8 Weld 37/24 = 14.9 kcmil #6 SOL	3/8	0.83	0.60	0.99	0.18	100	
LA0810AP-251	8 AWG	23 Navy #8 Weld 37/24 = 14.9 kcmil #6 SOL	#10	0.53	0.41	0.88	0.18	100	
LA0814AP-251	8 AWG	23 Navy #8 Weld 37/24 = 14.9 kcmil #6 SOL	1/4	0.62	0.48	0.88	0.18	100	
DA0810A	8 AWG	23 Navy #8 Weld 37/24 = 14.9 kcmil #6 SOL	#10	0.50	0.39	0.68	0.18	100	
DA0814A	8 AWG	23 Navy #8 Weld 37/24 = 14.9 kcmil #6 SOL	1/4	0.61	0.45	0.68	0.18	100	
DA0856A	8 AWG	23 Navy #8 Weld 37/24 = 14.9 kcmil #6 SOL	5/16	0.64	0.56	0.68	0.18	100	
DA0838A	8 AWG	23 Navy #8 Weld 37/24 = 14.9 kcmil #6 SOL	3/8	0.64	0.56	0.68	0.18	100	
DA0810A-250	8 AWG	23 Navy #8 Weld 37/24 = 14.9 kcmil #6 SOL	#10	0.53	0.41	—	0.00	100	
DA0814A-250	8 AWG	23 Navy #8 Weld 37/24 = 14.9 kcmil #6 SOL	1/4	0.62	0.48	—	0.00	100	
DA0856A-250	8 AWG	23 Navy #8 Weld 37/24 = 14.9 kcmil #6 SOL	5/16	0.74	0.56	—	0.00	100	
DA0838A-250	8 AWG	23 Navy #8 Weld 37/24 = 14.9 kcmil #6 SOL	3/8	0.84	0.60	—	0.00	100	
DA0814A-260	8 AWG	23 Navy #8 Weld 37/24 = 14.9 kcmil #6 SOL	1/4	0.64	0.44	0.62	0.18	100	
DA0856A-260	8 AWG	23 Navy #8 Weld 37/24 = 14.9 kcmil #6 SOL	5/16	0.70	0.52	0.62	0.18	100	
DA0838A-260	8 AWG	23 Navy #8 Weld 37/24 = 14.9 kcmil #6 SOL	3/8	0.83	0.58	0.62	0.18	100	
DA0812A-260	8 AWG	23 Navy #8 Weld 37/24 = 14.9 kcmil #6 SOL	1/2	1.08	0.71	0.62	0.18	100	
DA0810A-260	8 AWG	23 Navy #8 Weld 37/24 = 14.9 kcmil #6 SOL	8-10	0.52	0.41	0.62	0.18	100	
DA0810A-251	8 AWG	23 Navy #8 Weld 37/24 = 14.9 kcmil #6 SOL	#10	0.53	0.41	—	0.00	100	

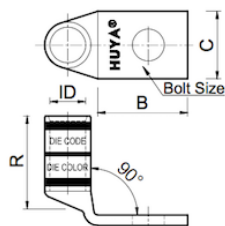

Installation Information

Manufacturer	Tools	Color	Code
T&B	TBM5 TBM8	Red	21
Panduit	CT-720 CT-920	Red	P21
Burndy	Y1MR Y2MR	Red	49
Celestra	A45	Red	21

Cat. Nos	Wire Size		Dimension (in.)					
	Code	Flex Class G,H,I,K,M	Bolt Size	B	C	R	ID	Std. Pkg.
DA0814A-251	8 AWG	23 Navy #8 Weld 37/24 = 14.9 kcmil #6 SOL	1/4	0.62	0.48	—	0.00	100
DA0856A-251	8 AWG	23 Navy #8 Weld 37/24 = 14.9 kcmil #6 SOL	5/16	0.74	0.56	—	0.00	100
DA0838A-251	8 AWG	23 Navy #8 Weld 37/24 = 14.9 kcmil #6 SOL	3/8	0.84	0.60	—	0.00	100
DA0810A-252	8 AWG	23 Navy #8 Weld 37/24 = 14.9 kcmil #6 SOL	#10	0.53	0.41	—	0.00	100
DA0814A-252	8 AWG	23 Navy #8 Weld 37/24 = 14.9 kcmil #6 SOL	1/4	0.62	0.48	—	0.00	100
DA0856A-252	8 AWG	23 Navy #8 Weld 37/24 = 14.9 kcmil #6 SOL	5/16	0.74	0.56	—	0.00	100
DA0838A-252	8 AWG	23 Navy #8 Weld 37/24 = 14.9 kcmil #6 SOL	3/8	0.84	0.60	—	0.00	100
DA0810A-261	8 AWG	23 Navy #8 Weld 37/24 = 14.9 kcmil #6 SOL	8-10	0.52	0.41	0.62	0.18	100
DA0814A-261	8 AWG	23 Navy #8 Weld 37/24 = 14.9 kcmil #6 SOL	1/4	0.64	0.44	0.62	0.18	100
DA0856A-261	8 AWG	23 Navy #8 Weld 37/24 = 14.9 kcmil #6 SOL	5/16	0.70	0.52	0.62	0.18	100
DA0838A-261	8 AWG	23 Navy #8 Weld 37/24 = 14.9 kcmil #6 SOL	3/8	0.83	0.58	0.62	0.18	100
DA0812A-261	8 AWG	23 Navy #8 Weld 37/24 = 14.9 kcmil #6 SOL	1/2	1.08	0.71	0.62	0.18	100