

# Metric connectors for copper conductor

One hole 45°

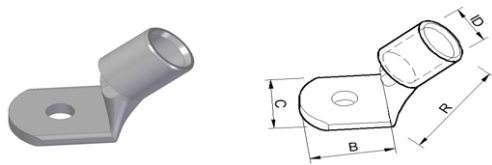

## Installation Information

Manufacturer	Tools	Color	Code
T&B	TBM62	--	-
Panduit	CT-100 CT1701	--	P10
Burndy	Y10D Y10R4BY	--	-
Celestra	A45	--	-

Cat. Nos	Conduct Size sq.mm				Stud	Dimensions mm					Std. Pkg.
	Stranded	Flexible	2r	5f / 6f		A	B	C	R	ID	
MC0605F-40	6	-	-	-	5.5	0.00	16.50	10.00	13.00	3.50	100
MC0606F-40	6	-	-	-	6.5	0.00	17.50	12.00	13.00	3.50	100
MC0608F-40	6	-	-	-	8.5	0.00	23.00	14.00	13.00	3.50	100
MC0610F-40	6	-	-	-	10.5	0.00	27.00	17.00	13.00	3.50	100
MC0612F-40	6	-	-	-	13	0.00	30.00	19.00	13.00	3.50	100

**Metric connectors for copper conductor**  
One hole 45°

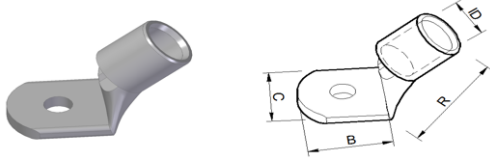

**Installation Information**

Manufacturer	Tools	Color	Code
T&B	TBM62 BPLT14	--	2
Panduit	CT-2001 CT-930	--	P21
Burndy	PAT600 Y35	--	49
Celestra	A45	--	2

Cat. Nos	Conduct Size sq.mm				Dimensions mm							Std. Pkg.
	Stranded	Flexible	2r	5f / 6f	Stud	A	B	C	R	ID		
MC1005F-50	10	-	-	-	5.5	0.00	15.80	10.50	28.80	4.50	100	
MC1006F-50	10	-	-	-	6.5	0.00	15.80	10.80	28.80	4.50	100	
MC1010F-50	10	-	-	-	10.5	0.00	16.50	15.00	28.80	4.40	100	
MC1005F-40	10	-	-	-	5.5	0.00	16.50	12.00	14.80	4.50	100	
MC1006F-40	10	-	-	-	6.5	0.00	16.50	12.00	14.80	4.50	100	
MC1008F-50	10	-	-	-	8.5	0.00	16.50	13.00	28.80	4.50	100	
MC1006F-30NH	10	-	-	-	6.5	0.00	18.00	11.00	14.80	4.50	100	
MC1006F-30	10	-	-	-	6.5	0.00	18.00	12.00	13.80	5.00	100	
MC1008F-30NH	10	-	-	-	8.5	0.00	20.50	13.00	14.80	4.50	100	
MC1008F-30	10	-	-	-	8.5	0.00	20.50	13.00	13.80	5.00	100	
MC1008F-40	10	-	-	-	8.5	0.00	23.00	15.00	14.80	4.50	100	
MC1010F-40	10	-	-	-	10.5	0.00	27.00	17.00	14.80	4.50	100	
MC1012F-40	10	-	-	-	13	0.00	31.00	19.00	14.80	4.50	100	

**Metric connectors for copper conductor**  
One hole 45°

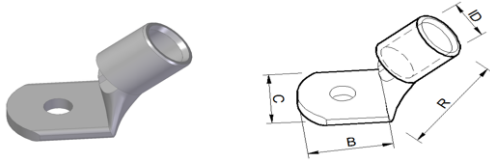

**Installation Information**

Manufacturer	Tools	Color	Code
T&B	TBM62 BPLT14	--	3
Panduit	CT-2001 CT-930	--	P24
Burndy	PAT600 Y35	--	7
Celestra	A45	--	3

Cat. Nos	Conduct Size sq.mm				Stud	Dimensions mm					Std. Pkg.
	Stranded	Flexible	2r	5f / 6f		A	B	C	R	ID	
MC1605F-50	16	-	-	-	5.5	0.00	16.80	11.50	32.30	5.50	100
MC1606F-50	16	-	-	-	6.5	0.00	16.80	11.50	32.30	5.50	100
MC1608F-50	16	-	-	-	8.5	0.00	16.80	13.00	32.30	5.50	100
MC1605F-40	16	-	-	-	5.5	0.00	17.50	12.00	18.10	5.50	100
MC1606F-30NH	16	-	-	-	6.5	0.00	18.00	12.00	20.10	5.40	100
MC1606F-30	16	-	-	-	6.5	0.00	18.00	13.00	17.10	6.00	100
MC1610F-50	16	-	-	-	10.5	0.00	18.20	15.00	32.30	5.50	100
MC1606F-40	16	-	-	-	6.5	0.00	18.50	12.00	18.10	5.50	100
MC1608F-30NH	16	-	-	-	8.5	0.00	20.50	12.00	20.10	5.40	100
MC1608F-30	16	-	-	-	8.5	0.00	20.50	13.50	17.10	6.00	100
MC1608F-40	16	-	-	-	8.5	0.00	23.00	15.00	18.10	5.50	100
MC1610F-30NH	16	-	-	-	10.5	0.00	25.00	16.00	20.10	5.40	100
MC1610F-40	16	-	-	-	10.5	0.00	27.00	17.00	18.10	5.50	100
MC1612F-40	16	-	-	-	13	0.00	31.00	19.00	18.10	5.50	100

**Metric connectors for copper conductor**  
One hole 45°

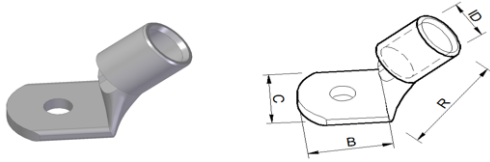

**Installation Information**

Manufacturer	Tools	Color	Code
T&B	TBM62 BPLT14	--	5
Panduit	CT-2001 CT-930	--	P29
Burndy	PAT600 Y35	--	9
Celestra	A45	--	5

Cat. Nos	Conduct Size sq.mm				Stud	Dimensions mm					Std. Pkg.
	Stranded	Flexible	2r	5f / 6f		A	B	C	R	ID	
MC2506F-50	25	-	-	-	6.5	0.00	18.00	14.00	33.20	6.90	100
MC2508F-50	25	-	-	-	8.5	0.00	18.00	15.50	33.20	6.90	100
MC2510F-50	25	-	-	-	10.5	0.00	18.00	15.50	33.20	6.90	100
MC2506F-30NH	25	-	-	-	6.5	0.00	18.00	14.00	23.00	7.00	100
MC2506F-30	25	-	-	-	6.5	0.00	18.00	17.00	17.50	8.00	100
MC2505F-40	25	-	-	-	5.5	0.00	18.50	14.00	21.50	7.00	100
MC2506F-40	25	-	-	-	6.5	0.00	18.50	14.00	21.50	7.00	100
MC2508F-30NH	25	-	-	-	8.5	0.00	20.50	14.00	23.00	7.00	100
MC2508F-30	25	-	-	-	8.5	0.00	20.50	17.00	17.50	8.00	100
MC2508F-40	25	-	-	-	8.5	0.00	23.00	16.00	21.50	7.00	100
MC2510F-30NH	25	-	-	-	10.5	0.00	25.00	15.00	23.00	7.00	100
MC2510F-30	25	-	-	-	10.5	0.00	25.00	17.00	17.50	8.00	100
MC2510F-40	25	-	-	-	10.5	0.00	27.00	18.00	21.50	7.00	100
MC2512F-40	25	-	-	-	13	0.00	31.00	19.00	21.50	7.00	100
MC2514F-40	25	-	-	-	15	0.00	34.50	21.00	21.50	7.00	100

**Metric connectors for copper conductor**  
One hole 45°

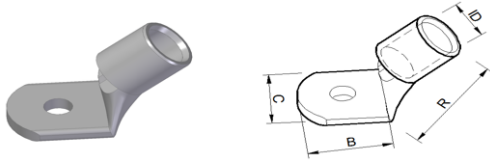

**Installation Information**

Manufacturer	Tools	Color	Code
T&B	TBM62 BPLT14	--	7
Panduit	CT-2001 CT-930	--	P29
Burndy	PAT600 Y35	--	10
Celestra	A45	--	7

Cat. Nos	Conduct Size sq.mm				Stud	Dimensions mm					Std. Pkg.
	Stranded	Flexible	2r	5f / 6f		A	B	C	R	ID	
MC3506F-30NH	35	-	-	-	6.5	0.00	18.00	17.00	28.20	8.50	100
MC3506F-30	35	-	-	-	6.5	0.00	18.00	18.00	20.50	9.00	100
MC3506F-40	35	-	-	-	6.5	0.00	18.50	17.00	23.50	8.50	100
MC3508F-30NH	35	-	-	-	8.5	0.00	20.50	17.00	28.20	8.50	100
MC3508F-30	35	-	-	-	8.5	0.00	20.50	18.00	20.50	9.00	100
MC3506F-50	35	-	-	-	6.5	0.00	20.80	15.50	39.30	8.20	100
MC3508F-50	35	-	-	-	8.5	0.00	20.80	15.50	39.30	8.20	100
MC3510F-50	35	-	-	-	10.5	0.00	20.80	15.50	39.30	8.20	100
MC3508F-40	35	-	-	-	8.5	0.00	23.00	17.00	23.50	8.50	100
MC3510F-30NH	35	-	-	-	10.5	0.00	25.00	18.00	28.20	8.50	100
MC3510F-30	35	-	-	-	10.5	0.00	25.00	18.00	20.50	9.00	100
MC3512F-50	35	-	-	-	13	0.00	26.00	21.50	39.30	8.20	100
MC3510F-40	35	-	-	-	10.5	0.00	27.00	19.00	23.50	8.50	100
MC3512F-40	35	-	-	-	13	0.00	31.00	21.00	23.50	8.50	100
MC3514F-40	35	-	-	-	15	0.00	34.50	21.00	23.50	8.50	100
MC3516F-40	35	-	-	-	17	0.00	38.00	26.00	23.50	8.50	100

**Metric connectors for copper conductor**  
One hole 45°

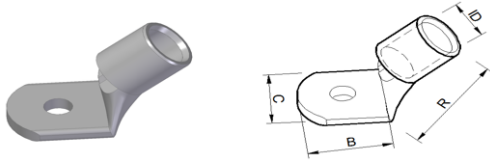

**Installation Information**

Manufacturer	Tools	Color	Code
T&B	TBM62 BPLT14	--	10
Panduit	CT-2001 CT-930	--	P37
Burndy	PAT600 Y35	--	12
Celestra	A45	--	10

Cat. Nos	Conduct Size sq.mm				Stud	Dimensions mm					Std. Pkg.
	Stranded	Flexible	2r	5f / 6f		A	B	C	R	ID	
MC5006F-50	50	-	-	-	6.5	0.00	21.50	18.00	43.80	9.80	100
MC5008F-50	50	-	-	-	8.5	0.00	21.50	18.00	43.80	9.80	100
MC5010F-50	50	-	-	-	10.5	0.00	21.50	18.00	43.80	9.80	100
MC5006F-40	50	-	-	-	6.5	0.00	23.00	20.00	26.20	10.00	100
MC5008F-40	50	-	-	-	8.5	0.00	23.00	20.00	26.20	10.00	100
MC5012F-50	50	-	-	-	13	0.00	25.00	23.00	43.80	9.80	100
MC5008F-30NH	50	-	-	-	8.5	0.00	26.00	20.00	30.90	10.00	100
MC5008F-30	50	-	-	-	8.5	0.00	26.00	21.00	27.90	11.00	100
MC5010F-40	50	-	-	-	10.5	0.00	28.00	20.00	26.20	10.00	100
MC5010F-30NH	50	-	-	-	10.5	0.00	30.00	20.00	30.90	10.00	100
MC5010F-30	50	-	-	-	10.5	0.00	30.00	21.00	27.90	11.00	100
MC5012F-40	50	-	-	-	13	0.00	31.00	23.00	26.20	10.00	100
MC5012F-30NH	50	-	-	-	13	0.00	32.00	21.00	30.90	10.00	100
MC5012F-30	50	-	-	-	13	0.00	32.00	21.00	27.90	11.00	100
MC5014F-40	50	-	-	-	15	0.00	34.50	23.00	26.20	10.00	100
MC5016F-40	50	-	-	-	17	0.00	38.00	28.00	26.20	10.00	100
MC5020F-40	50	-	-	-	21	0.00	43.00	30.00	26.20	10.00	100

**Metric connectors for copper conductor**  
One hole 45°

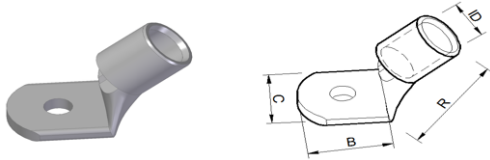

**Installation Information**

Manufacturer	Tools	Color	Code
T&B	TBM62 BPLT14	--	14
Panduit	CT-2001 CT-930	--	P45
Burndy	PAT600 Y35	--	13
Celestra	A45	--	14

Cat. Nos	Conduct Size sq.mm				Stud	Dimensions mm					Std. Pkg.
	Stranded	Flexible	2r	5f / 6f		A	B	C	R	ID	
MC7006F-40	70	-	-	-	6.5	0.00	23.00	23.00	29.10	12.00	100
MC7008F-40	70	-	-	-	8.5	0.00	24.00	23.00	29.10	12.00	100
MC7006F-50	70	-	-	-	6.5	0.00	26.00	20.80	46.10	11.50	100
MC7008F-50	70	-	-	-	8.5	0.00	26.00	20.80	46.10	11.50	100
MC7010F-50	70	-	-	-	10.5	0.00	26.00	20.80	46.10	11.50	100
MC7012F-50	70	-	-	-	13	0.00	26.00	20.80	46.10	11.50	100
MC7008F-30NH	70	-	-	-	8.5	0.00	26.00	23.00	32.50	12.00	100
MC7008F-30	70	-	-	-	8.5	0.00	26.00	25.00	28.10	13.00	100
MC7010F-40	70	-	-	-	10.5	0.00	28.00	23.00	29.10	12.00	100
MC7010F-30NH	70	-	-	-	10.5	0.00	30.00	23.00	32.50	12.00	100
MC7010F-30	70	-	-	-	10.5	0.00	30.00	25.00	28.10	13.00	100
MC7012F-40	70	-	-	-	13	0.00	31.00	23.00	29.10	12.00	100
MC7012F-30NH	70	-	-	-	13	0.00	32.00	23.00	32.50	12.00	100
MC7012F-30	70	-	-	-	13	0.00	32.00	25.00	28.10	13.00	100
MC7014F-40	70	-	-	-	15	0.00	34.50	23.00	29.10	12.00	100
MC7016F-40	70	-	-	-	17	0.00	38.00	28.00	29.10	12.00	100
MC7020F-40	70	-	-	-	21	0.00	43.00	30.00	29.10	12.00	100

# Metric connectors for copper conductor

One hole 45°

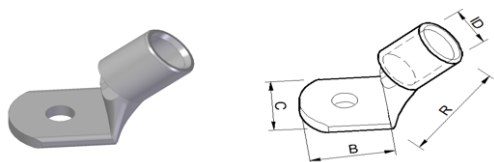

## Installation Information

Manufacturer	Tools	Color	Code
T&B	TBM62 BPLT14	--	19
Panduit	CT-2001 CT-930	--	P54
Burndy	MY29 Y644M	--	14
Celestra	A45	--	19

Cat. Nos	Conduct Size sq.mm				Dimensions mm						
	Stranded	Flexible	2r	5f / 6f	Stud	A	B	C	R	ID	Std. Pkg.
MC9508F-30NH	95	-	-	-	8.5	0.00	26.00	26.00	36.60	13.50	100
MC9508F-40	95	-	-	-	8.5	0.00	26.00	26.00	33.10	13.50	100
MC9508F-50	95	-	-	-	8.5	0.00	28.50	24.50	51.10	13.50	100
MC9510F-50	95	-	-	-	10.5	0.00	28.50	24.50	51.10	13.50	100
MC9512F-50	95	-	-	-	13	0.00	28.50	24.50	51.10	13.50	100
MC9516F-50	95	-	-	-	17	0.00	28.50	24.50	51.10	13.50	100
MC9510F-40	95	-	-	-	10.5	0.00	29.00	26.00	33.10	13.50	100
MC9510F-30NH	95	-	-	-	10.5	0.00	30.00	26.00	36.60	13.50	100
MC9510F-30	95	-	-	-	10.5	0.00	30.00	29.00	31.10	15.00	100
MC9512F-40	95	-	-	-	13	0.00	31.00	26.00	33.10	13.50	100
MC9512F-30NH	95	-	-	-	13	0.00	32.00	26.00	36.60	13.50	100
MC9512F-30	95	-	-	-	13	0.00	32.00	29.00	31.10	15.00	100
MC9514F-40	95	-	-	-	15	0.00	34.50	26.00	33.10	13.50	100
MC9516F-30NH	95	-	-	-	17	0.00	36.00	27.00	36.60	13.50	100
MC9516F-30	95	-	-	-	17	0.00	36.00	29.00	31.10	15.00	100
MC9516F-40	95	-	-	-	17	0.00	38.00	28.00	33.10	13.50	100
MC9520F-40	95	-	-	-	21	0.00	46.00	36.00	33.10	13.50	100



**Metric connectors for copper conductor**  
One hole 45°

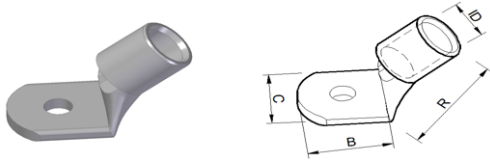

**Installation Information**

Manufacturer	Tools	Color	Code
T&B	TBM62 BPLT14	--	24
Panduit	CT-2001 CT-930	--	P62
Burndy	PAT600 Y35	--	15
Celestra	A45	--	24

Cat. Nos	Conduct Size sq.mm				Dimensions mm						
	Stranded	Flexible	2r	5f / 6f	Stud	A	B	C	R	ID	Std. Pkg.
MC1210F-30NH	120	-	-	-	10.5	0.00	30.00	28.00	38.90	15.00	100
MC1208F-40	120	-	-	-	8.5	0.00	30.00	28.00	34.90	15.00	100
MC1208F-50	120	-	-	-	8.5	0.00	30.00	27.50	48.60	15.20	100
MC1210F-50	120	-	-	-	10.5	0.00	30.00	27.50	48.60	15.20	100
MC1212F-50	120	-	-	-	13	0.00	30.00	27.50	48.60	15.20	100
MC1216F-50	120	-	-	-	17	0.00	30.00	27.50	48.60	15.20	100
MC1210F-30	120	-	-	-	10.5	0.00	30.00	32.00	33.90	17.00	100
MC1210F-40	120	-	-	-	10.5	0.00	31.00	28.00	34.90	15.00	100
MC1212F-30NH	120	-	-	-	13	0.00	32.00	28.00	38.90	15.00	100
MC1212F-40	120	-	-	-	13	0.00	32.00	28.00	34.90	15.00	100
MC1212F-30	120	-	-	-	13	0.00	32.00	32.00	33.90	17.00	100
MC1214F-40	120	-	-	-	15	0.00	35.00	28.00	34.90	15.00	100
MC1216F-30NH	120	-	-	-	17	0.00	36.00	28.00	38.90	15.00	100
MC1216F-30	120	-	-	-	17	0.00	36.00	32.00	33.90	17.00	100
MC1216F-40	120	-	-	-	17	0.00	38.00	30.00	34.90	15.00	100
MC1220F-40	120	-	-	-	21	0.00	46.00	36.00	34.90	15.00	100

**Metric connectors for copper conductor**  
One hole 45°

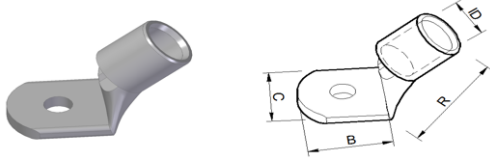

**Installation Information**

Manufacturer	Tools	Color	Code
T&B	TBM62 BPLT14	--	30
Panduit	CT-2001 CT-930	--	P66
Burndy	PAT600 Y35	--	17
Celestra	A45	--	30

Cat. Nos	Conduct Size sq.mm				Dimensions mm						
	Stranded	Flexible	2r	5f / 6f	Stud	A	B	C	R	ID	Std. Pkg.
MC1508F-40	150	-	-	-	8.5	0.00	30.00	31.00	40.20	16.50	100
MC1510F-30	150	-	-	-	10.5	0.00	30.00	36.00	40.20	19.00	100
MC1510F-40	150	-	-	-	10.5	0.00	31.00	31.00	40.20	16.50	100
MC1512F-30	150	-	-	-	13	0.00	32.00	36.00	40.20	19.00	100
MC1512F-40	150	-	-	-	13	0.00	33.00	31.00	40.20	16.50	100
MC1508F-50	150	-	-	-	8.5	0.00	34.50	30.50	67.20	16.50	100
MC1510F-50	150	-	-	-	10.5	0.00	34.50	30.50	67.20	16.50	100
MC1512F-50	150	-	-	-	13	0.00	34.50	30.50	67.20	16.50	100
MC1516F-50	150	-	-	-	17	0.00	34.50	30.50	67.20	16.50	100
MC1514F-40	150	-	-	-	15	0.00	35.00	31.00	40.20	16.50	100
MC1516F-30	150	-	-	-	17	0.00	36.00	36.00	40.20	19.00	100
MC1516F-40	150	-	-	-	17	0.00	38.00	31.00	40.20	16.50	100
MC1520F-50	150	-	-	-	21	0.00	38.50	30.50	67.20	16.50	100
MC1520F-40	150	-	-	-	21	0.00	46.00	36.00	40.20	16.50	100

# Metric connectors for copper conductor

One hole 45°

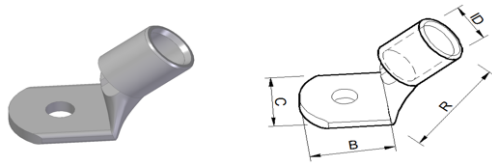

## Installation Information

Manufacturer	Tools	Color	Code
T&B	TBM62 BPLT14	--	37
Panduit	CT-2001 CT-930	--	P76
Burndy	PAT600 Y35	--	18
Celestra	A45	--	37

Cat. Nos	Conduct Size sq.mm				Stud	Dimensions mm					Std. Pkg.
	Stranded	Flexible	2r	5f / 6f		A	B	C	R	ID	
MC1810F-50	185	-	-	-	10.5	0.00	35.50	33.50	69.00	18.60	100
MC1812F-50	185	-	-	-	13	0.00	35.50	33.50	69.00	18.60	100
MC1816F-50	185	-	-	-	17	0.00	35.50	33.50	69.00	18.60	100
MC1820F-50	185	-	-	-	21	0.00	38.50	33.50	69.00	18.60	100
MC1810F-40	185	-	-	-	10.5	0.00	40.00	35.00	42.70	19.00	100
MC1812F-40	185	-	-	-	13	0.00	40.00	35.00	42.70	19.00	100
MC1814F-40	185	-	-	-	15	0.00	40.00	35.00	42.70	19.00	100
MC1816F-40	185	-	-	-	17	0.00	40.00	35.00	42.70	19.00	100
MC1820F-40	185	-	-	-	21	0.00	46.00	39.00	42.70	19.00	100

# Metric connectors for copper conductor

One hole 45°

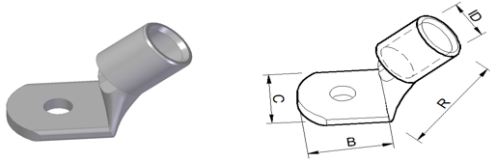

## Installation Information

Manufacturer	Tools	Color	Code
T&B	TBM62 BPLT14	--	48
Panduit	CT-2001 CT-930	--	P87
Burndy	PAT600 Y35	--	20
Celestra	A45	--	48

Cat. Nos	Conduct Size sq.mm				Stud	Dimensions mm					Std. Pkg.
	Stranded	Flexible	2r	5f / 6f		A	B	C	R	ID	
MC2410F-50	240	-	-	-	10.5	0.00	40.50	37.50	79.80	20.80	100
MC2412F-50	240	-	-	-	13	0.00	40.50	37.50	79.80	20.80	100
MC2416F-50	240	-	-	-	17	0.00	40.50	37.50	79.80	20.80	100
MC2420F-50	240	-	-	-	21	0.00	40.50	37.50	79.80	20.80	100
MC2410F-40	240	-	-	-	10.5	0.00	43.50	39.00	51.30	21.00	100
MC2412F-40	240	-	-	-	13	0.00	43.50	39.00	51.30	21.00	100
MC2414F-40	240	-	-	-	15	0.00	43.50	39.00	51.30	21.00	100
MC2416F-40	240	-	-	-	17	0.00	43.50	39.00	51.30	21.00	100
MC2420F-40	240	-	-	-	21	0.00	45.50	39.00	51.30	21.00	100

**Metric connectors for copper conductor**  
One hole 45°

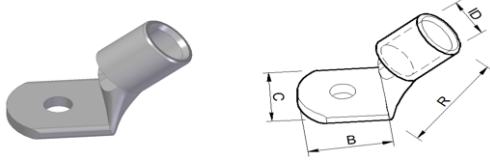

**Installation Information**

Manufacturer	Tools	Color	Code
T&B	BPLT14	--	60
Panduit	CT-930 CT-940	--	P94
Burndy	PAT750 Y35	--	22
Celestra	A45	--	60

Cat. Nos	Conduct Size sq.mm				Stud	Dimensions mm					Std. Pkg.
	Stranded	Flexible	2r	5f / 6f		A	B	C	R	ID	
MC3110F-50	300	-	-	-	10.5	0.00	42.00	42.50	86.20	23.50	100
MC3112F-50	300	-	-	-	13	0.00	42.00	42.50	86.20	23.50	100
MC3116F-50	300	-	-	-	17	0.00	42.00	42.50	86.20	23.50	100
MC3120F-50	300	-	-	-	21	0.00	42.00	42.50	86.20	23.50	100
MC3112F-40	300	-	-	-	13	0.00	48.00	43.00	61.80	23.50	100
MC3114F-40	300	-	-	-	15	0.00	48.00	43.00	61.80	23.50	100
MC3116F-40	300	-	-	-	17	0.00	48.00	43.00	61.80	23.50	100
MC3120F-40	300	-	-	-	21	0.00	48.00	43.00	61.80	23.50	100

# Metric connectors for copper conductor

One hole 45°

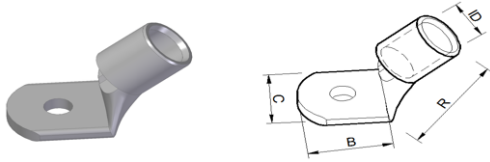

## Installation Information

Manufacturer	Tools	Color	Code
T&B	BPLT14 TBM26	--	80
Panduit	CT-930 CT-940	--	P106
Burndy	PAT750 Y35	--	24
Celestra	A45	--	80

Cat. Nos	Conduct Size sq.mm				Stud	Dimensions mm					Std. Pkg.
	Stranded	Flexible	2r	5f / 6f		A	B	C	R	ID	
MC4112F-40	400	-	-	-	13	0.00	48.00	49.00	65.30	27.00	100
MC4114F-40	400	-	-	-	15	0.00	48.00	49.00	65.30	27.00	100
MC4116F-40	400	-	-	-	17	0.00	48.00	49.00	65.30	27.00	100
MC4120F-40	400	-	-	-	21	0.00	48.00	49.00	65.30	27.00	100
MC4110F-50	400	-	-	-	10.5	0.00	50.00	48.00	94.30	26.20	100
MC4112F-50	400	-	-	-	13	0.00	50.00	48.00	94.30	26.20	100
MC4116F-50	400	-	-	-	17	0.00	50.00	48.00	94.30	26.20	100
MC4120F-50	400	-	-	-	21	0.00	50.00	48.00	94.30	26.20	100