

Installation Information

Manufacturer	Tools	Color	Code
T&B	TBM5 TBM8	Pink	42
Panduit	CT-720 CT-920	Pink	P42
Burndy	MY29 Y644M	Pink	12
Celestra	A45	Pink	42

Cat. Nos	Wire Size		Dimension (in.)						
	Code	Flex Class G,H,I,K,M	Bolt Size	B	C	R	ID	Std. Pkg.	
DA1014A	1/0AWG	100 Navy #1 Weld 225/24 = 90.8 kcmil 133/.0254	1/4	0.65	0.75	0.98	0.40	100	
DA1056A	1/0AWG	100 Navy #1 Weld 225/24 = 90.8 kcmil 133/.0254	5/16	0.88	0.75	0.98	0.40	100	
DA1038A	1/0AWG	100 Navy #1 Weld 225/24 = 90.8 kcmil 133/.0254	3/8	0.93	0.75	0.98	0.40	100	
DA1012A	1/0AWG	100 Navy #1 Weld 225/24 = 90.8 kcmil 133/.0254	1/2	1.25	0.75	0.98	0.40	100	
LA1010A	1/0AWG	100 Navy #1 Weld 225/24 = 90.8 kcmil 133/.0254	#10	0.65	0.75	1.33	0.40	100	
LA1056A	1/0AWG	100 Navy #1 Weld 225/24 = 90.8 kcmil 133/.0254	5/16	0.88	0.75	1.33	0.40	100	
LA1038A	1/0AWG	100 Navy #1 Weld 225/24 = 90.8 kcmil 133/.0254	3/8	0.93	0.75	1.33	0.40	100	
LA1012A	1/0AWG	100 Navy #1 Weld 225/24 = 90.8 kcmil 133/.0254	1/2	1.25	0.75	1.33	0.40	100	
DA1014A-250	1/0 AWG	100 Navy #1 Weld 225/24 = 90.8 kcmil 133/.0254	1/4	0.70	0.76	1.22	0.39	100	
DA1056A-250	1/0 AWG	100 Navy #1 Weld 225/24 = 90.8 kcmil 133/.0254	5/16	0.76	0.76	1.22	0.39	100	
DA1038A-250	1/0 AWG	100 Navy #1 Weld 225/24 = 90.8 kcmil 133/.0254	3/8	0.83	0.76	1.22	0.39	100	
DA1012A-250	1/0 AWG	100 Navy #1 Weld 225/24 = 90.8 kcmil 133/.0254	1/2	1.07	0.80	1.22	0.39	100	
DA1014A-260	1/0 AWG	100 Navy #1 Weld 225/24 = 90.8 kcmil 133/.0254	1/4	0.64	0.75	1.16	0.39	100	
DA1038A-260	1/0 AWG	100 Navy #1 Weld 225/24 = 90.8 kcmil 133/.0254	3/8	0.83	0.75	1.16	0.39	100	
DA1012A-260	1/0 AWG	100 Navy #1 Weld 225/24 = 90.8 kcmil 133/.0254	1/2	1.08	0.75	1.16	0.39	100	
DA1056A-260	1/0 AWG	100 Navy #1 Weld 225/24 = 90.8 kcmil 133/.0254	5/16	0.70	0.88	1.16	0.39	100	
DA1014A-251	1/0 AWG	275/24 1/0 Weld	1/4	0.78	0.85	1.00	0.45	100	
DA1056A-251	1/0 AWG	275/24 1/0 Weld	5/16	0.78	0.85	1.00	0.45	100	
DA1038A-251	1/0 AWG	275/24 1/0 Weld	3/8	0.84	0.85	1.00	0.45	100	
DA1012A-251	1/0 AWG	275/24 1/0 Weld	1/2	1.09	0.85	1.00	0.45	100	
DA1014A-252	1/0 AWG	100 Navy #1 Weld 225/24 = 90.8 kcmil 133/.0254	1/4	0.70	0.76	0.94	0.39	100	
DA1056A-252	1/0 AWG	100 Navy #1 Weld 225/24 = 90.8 kcmil 133/.0254	5/16	0.76	0.76	0.94	0.39	100	
DA1038A-252	1/0 AWG	100 Navy #1 Weld 225/24 = 90.8 kcmil 133/.0254	3/8	0.83	0.76	0.94	0.39	100	
DA1012A-252	1/0 AWG	100 Navy #1 Weld 225/24 = 90.8 kcmil 133/.0254	1/2	1.07	0.80	0.94	0.39	100	
DA1012A-261	1/0 AWG	275/24 1/0 Weld	1/2	1.08	0.83	0.97	0.44	100	
DA1014A-261	1/0 AWG	275/24 1/0 Weld	1/4	0.64	0.83	0.97	0.44	100	
DA1038A-261	1/0 AWG	275/24 1/0 Weld	3/8	0.83	0.83	0.97	0.44	100	
DA1056A-261	1/0 AWG	275/24 1/0 Weld	5/16	0.70	0.83	0.97	0.44	100	
WP1038A-022	1/0 AWG	100 Navy #1 Weld 225/24 = 90.8 kcmil 133/.0254	3/8	0.81	0.74	0.91	0.40	100	
LA1010A-250	1/0 AWG	100 Navy #1 Weld 225/24 = 90.8 kcmil 133/.0254	#10	0.56	0.76	1.72	0.39	100	
LA1056A-250	1/0 AWG	100 Navy #1 Weld 225/24 = 90.8 kcmil 133/.0254	5/16	0.76	0.76	1.72	0.39	100	
LA1038A-250	1/0 AWG	100 Navy #1 Weld 225/24 = 90.8 kcmil 133/.0254	3/8	0.83	0.76	1.72	0.39	100	
LA1012A-250	1/0 AWG	100 Navy #1 Weld 225/24 = 90.8 kcmil 133/.0254	1/2	1.07	0.80	1.72	0.39	100	
LA1010A-260	1/0 AWG	100 Navy #1 Weld 225/24 = 90.8 kcmil 133/.0254	#10	0.52	0.75	1.66	0.39	100	

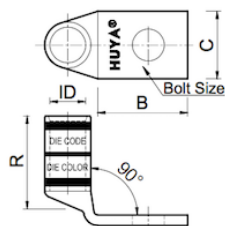

Installation Information

Manufacturer	Tools	Color	Code
T&B	TBM5 TBM8	Pink	42
Panduit	CT-720 CT-920	Pink	P42
Burndy	MY29 Y644M	Pink	12
Celestra	A45	Pink	42

Cat. Nos	Wire Size		Dimension (in.)					Std. Pkg.
	Code	Flex Class G,H,I,K,M	Bolt Size	B	C	R	ID	
LA1056A-260	1/0 AWG	100 Navy #1 Weld 225/24 = 90.8 kcmil 133/.0254	5/16	0.70	0.75	1.66	0.39	100
LA1038A-260	1/0 AWG	100 Navy #1 Weld 225/24 = 90.8 kcmil 133/.0254	3/8	0.83	0.75	1.66	0.39	100
LA1012A-260	1/0 AWG	100 Navy #1 Weld 225/24 = 90.8 kcmil 133/.0254	1/2	1.08	0.81	1.66	0.39	100
LA1056AP-260	1/0 AWG	100 Navy #1 Weld 225/24 = 90.8 kcmil 133/.0254	5/16	0.70	0.75	1.66	0.39	100
LA1038AP-260	1/0 AWG	100 Navy #1 Weld 225/24 = 90.8 kcmil 133/.0254	3/8	0.83	0.75	1.66	0.39	100
LA1012AP-260	1/0 AWG	100 Navy #1 Weld 225/24 = 90.8 kcmil 133/.0254	1/2	1.08	0.83	1.66	0.39	100
LA1014AP-251	1/0 AWG	275/24 1/0 Weld	1/4	0.80	0.85	1.78	0.45	100
LA1038AP-251	1/0 AWG	275/24 1/0 Weld	3/8	0.84	0.85	1.78	0.45	100
LA1012AP-251	1/0 AWG	275/24 1/0 Weld	1/2	1.09	0.85	1.78	0.45	100
LA1014AP-261	1/0 AWG	275/24 1/0 Weld	1/4	0.64	0.83	1.66	0.44	100
LA1038AP-261	1/0 AWG	275/24 1/0 Weld	3/8	0.83	0.83	1.66	0.44	100
LA1012AP-261	1/0 AWG	275/24 1/0 Weld	1/2	1.08	0.83	1.66	0.44	100